

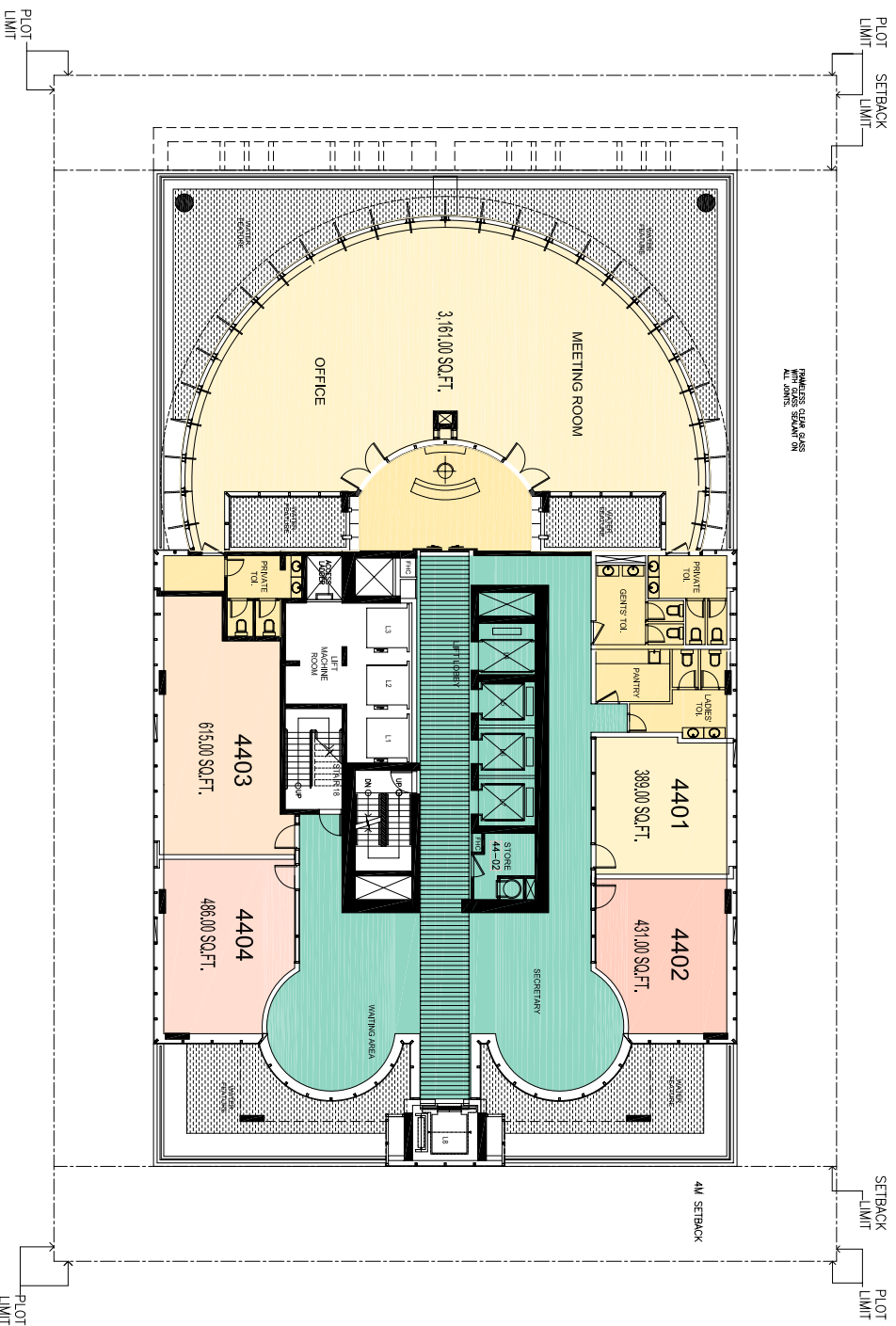

SHEIKH ZAYED ROAD 



ROUNDAABOUT SIDE



4B+G+44+M COMM.+OFFICE BUILDING  
on PLOT NO-G2 ( JBC 1 )  
JUMIRAH LAKE TOWERS, DUBAI



CLIENT  
AL FAIER PROPERTIES (L.L.C.)

DRAWING NO. SP-G2-46  
44TH FLOOR PLAN  
21 MAY 2008