

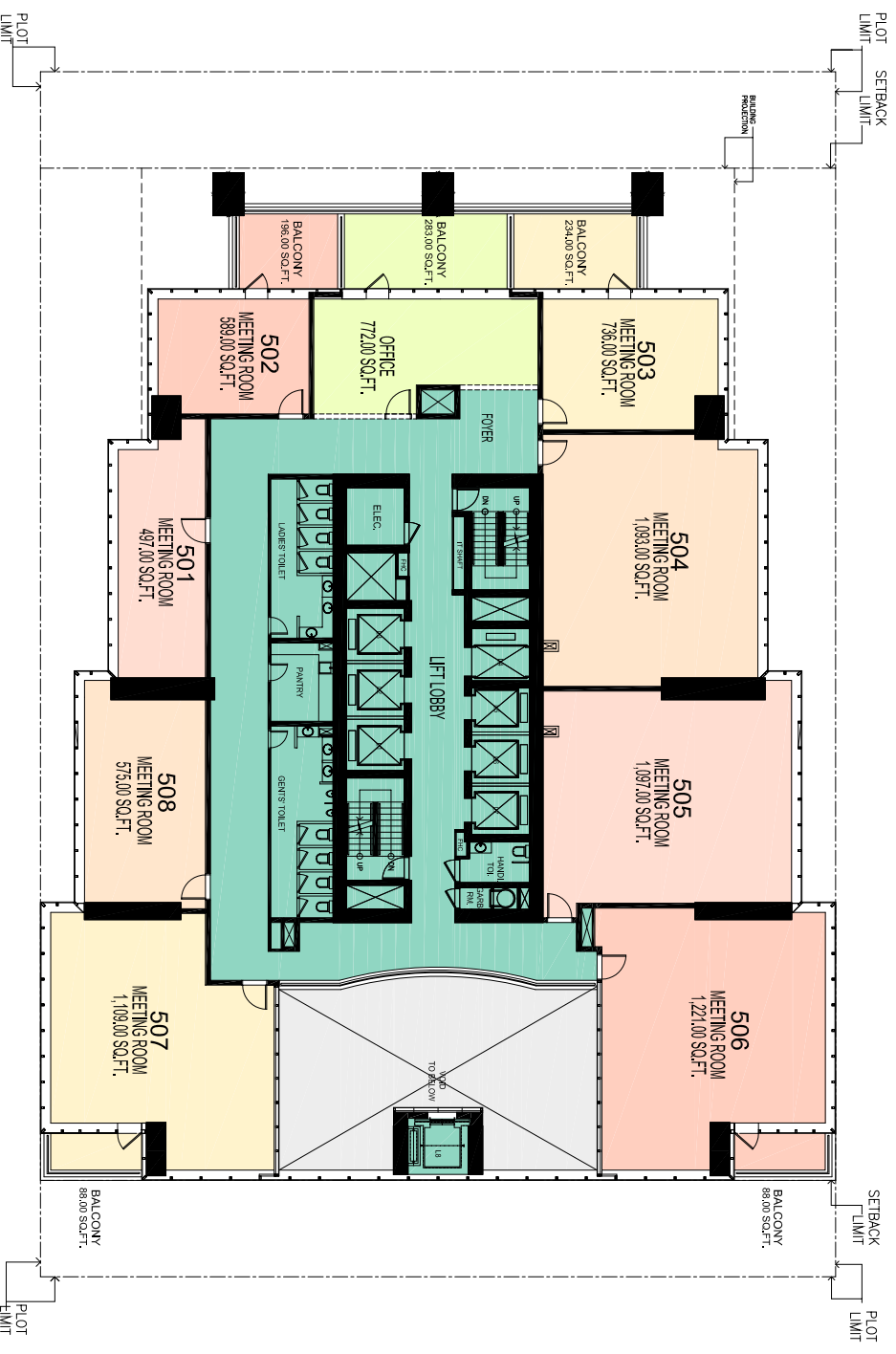

SHEIKH ZAYED ROAD 



ROUNDBABOUT SIDE



4B+G+44+M COMM.+OFFICE BUILDING
on PLOT NO-G2 (JBC 1)
JUMEIRAH LAKE TOWERS, DUBAI



CLIENT
AL FAJER PROPERTIES (L.L.C.)

DRAWING NO. SP-G2-07
BUSINESS CENTRE
5TH FLOOR PLAN
21 MAY 2008