

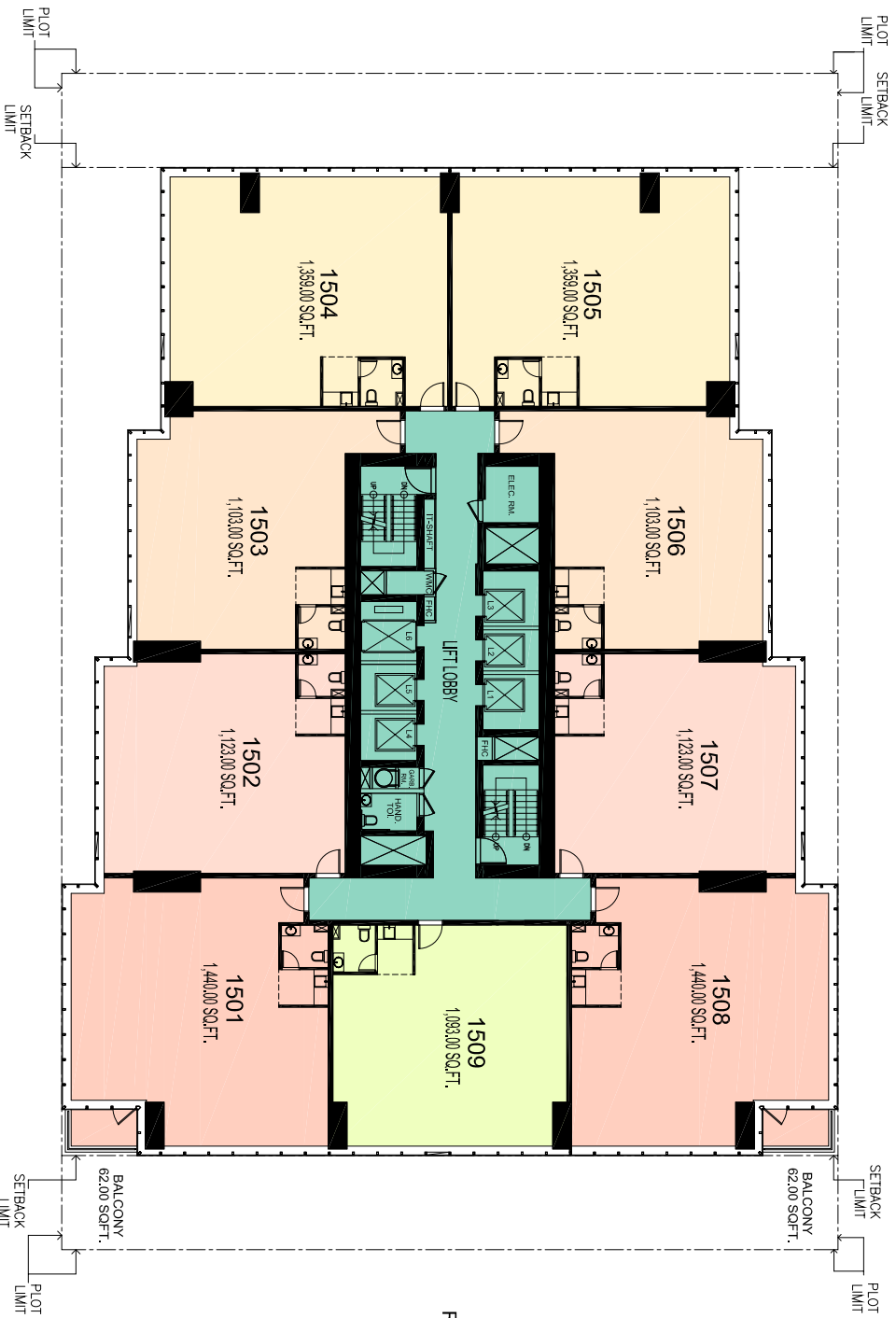

SHEIKH ZAYED ROAD



ROUNDAABOUT SIDE



4B+G+39+M COMM. +OFFICE BUILDING  
ON PLOT NO-V1 ( JBC 2)  
JUMIRAH LAKE TOWERS, DUBAI



CLIENT  
AL FAJER PROPERTIES (L.L.C.)

DRAWING NO. SP-V1-17  
15TH FLOOR PLAN  
21/MAY/2008