

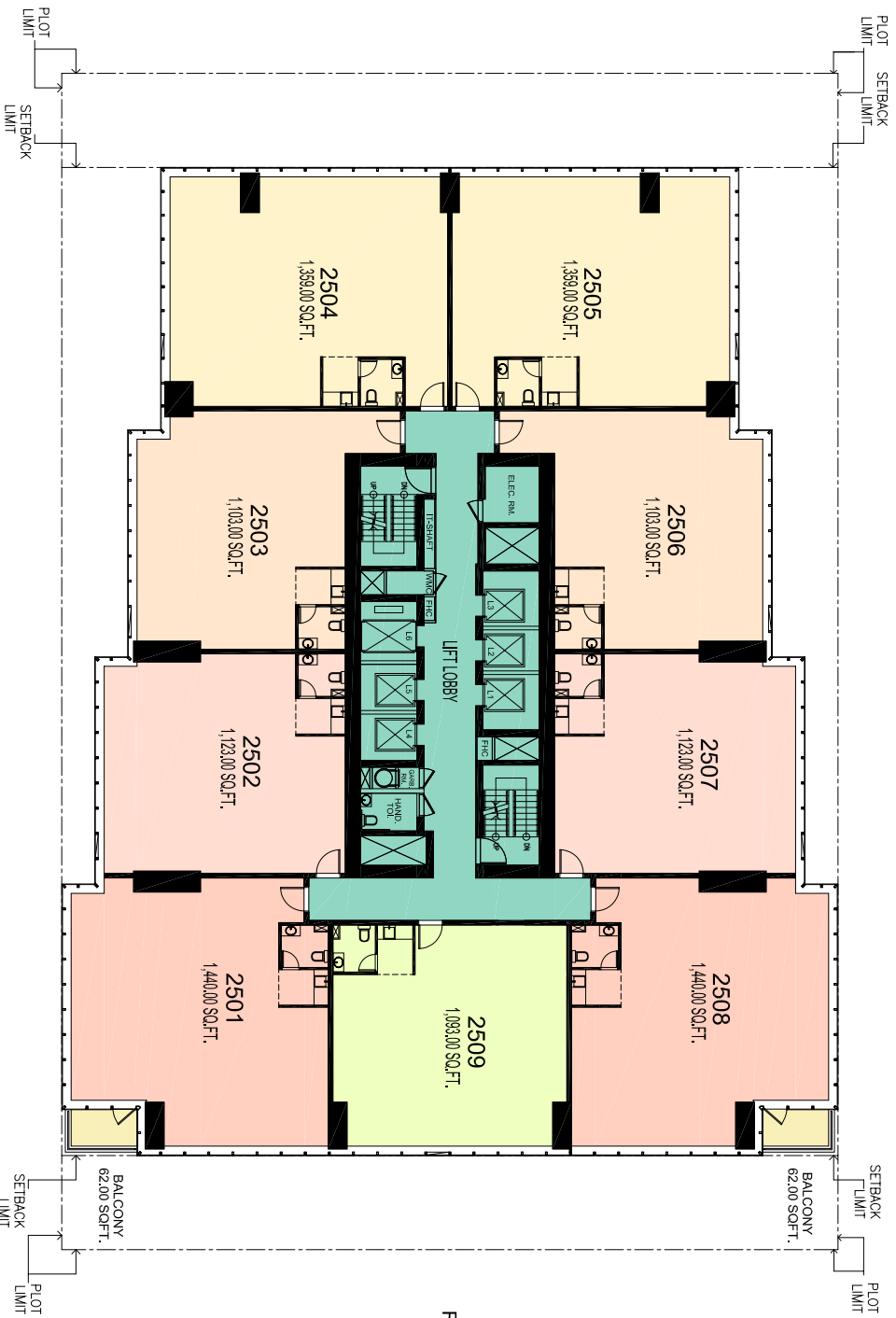

SHEIKH ZAYED ROAD



ROUNDAABOUT SIDE



4B+G+39+M COMM.+OFFICE BUILDING
ON PLOT NO-V1 (JBC 2)
JUMERAH LAKE TOWERS, DUBAI



CLIENT
AL FALGER PROPERTIES (L.L.C.)

DRAWING NO. SP-V1-Z7
25TH FLOOR PLAN
21/MAY/2008