

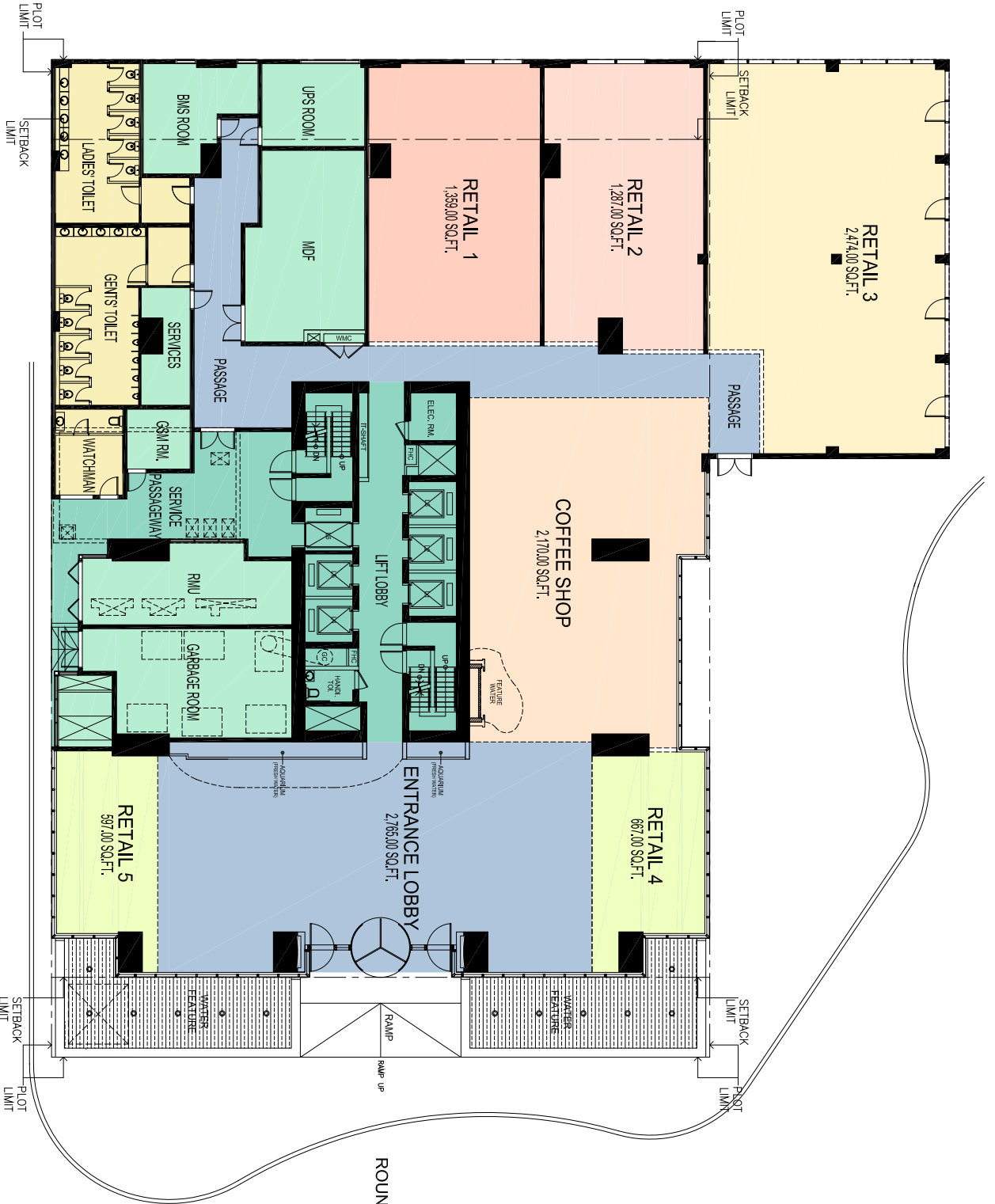

SHEIKH ZAYED ROAD



ROUNDAABOUT SIDE



4B+G+39+M COMM.+OFFICE BUILDING
ON PLOT NO-V1 (JBC 2)
JUMIRAH LAKE TOWERS, DUBAI



CLIENT
AL FAIER PROPERTIES (L.L.C.)

DRAWING NO. : SP-V1-02
GROUND FLOOR PLAN
21 MAY 2008