

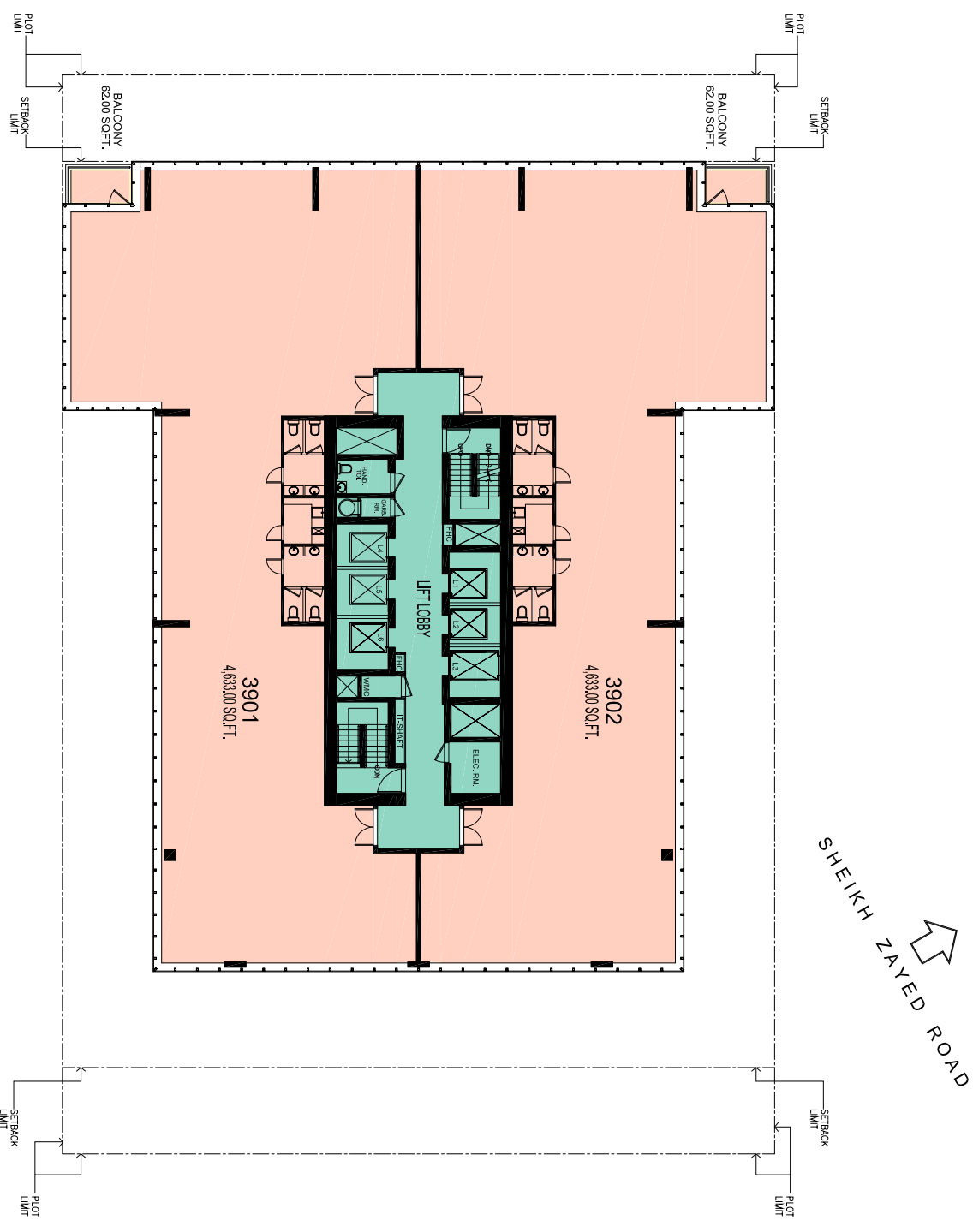

ROUNDBABOUT SIDE



4B+G+39+M COMM +OFFICE BUILDING
ON PLOT NO-Y1 (JBC 3)
JUMIRAH LAKE TOWERS, DUBAI



CLIENT
AL FAIER PROPERTIES (L.L.C.)

DRAWING NO. SP-Y1-41
39TH FLOOR PLAN
21 MAY 2008