

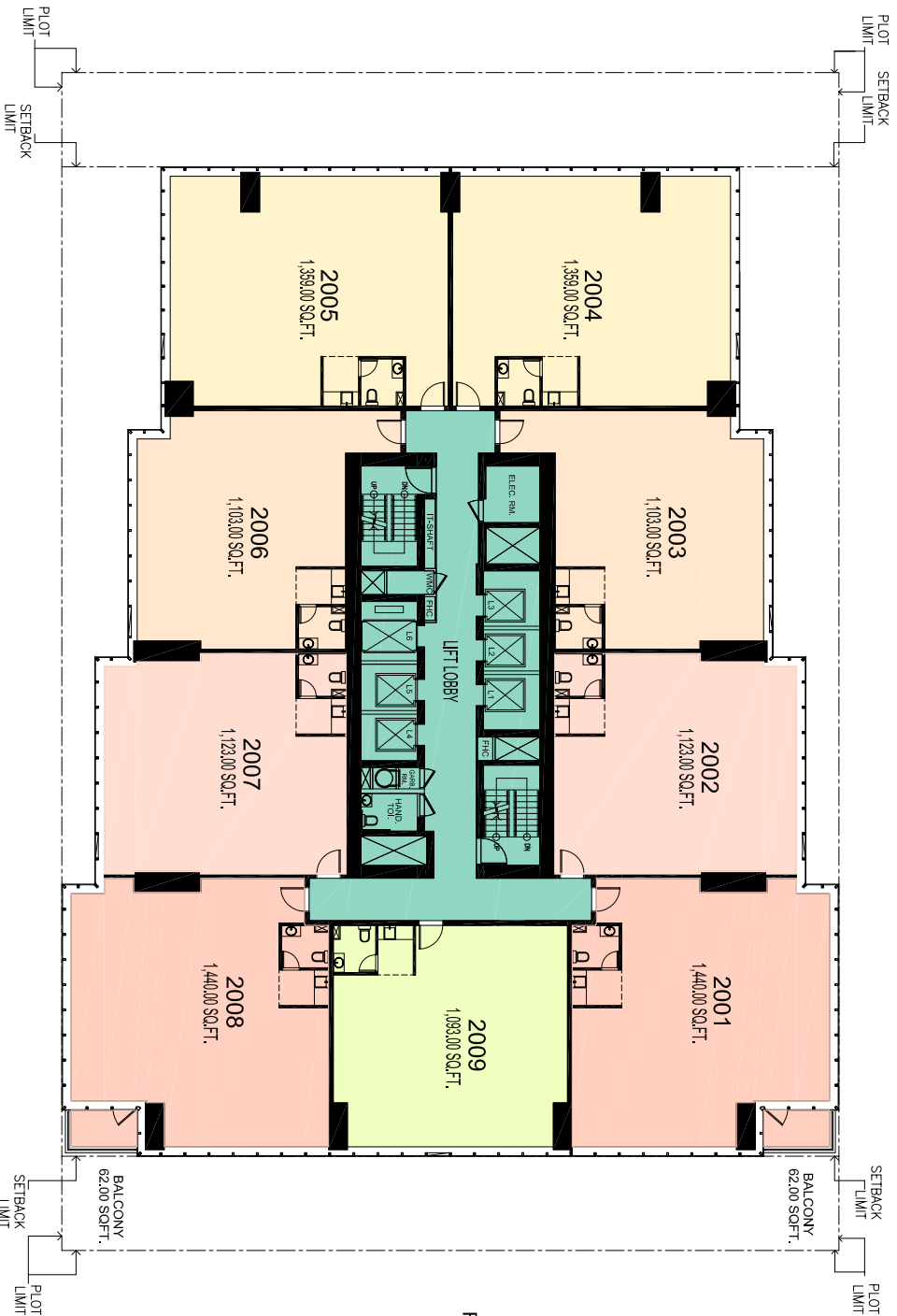

SHEIKH ZAYED ROAD 



ROUNDBABOUT SIDE



4B+G+39+M COMM.+OFFICE BUILDING  
on PLOT NO-W1 ( JBC 5)  
JUMIRAH LAKE TOWERS, DUBAI



CLIENT  
AL FAJER PROPERTIES (L.L.C.)

DRAWING NO. SP-W1-22  
20TH FLOOR PLAN  
21 MAY 2008