

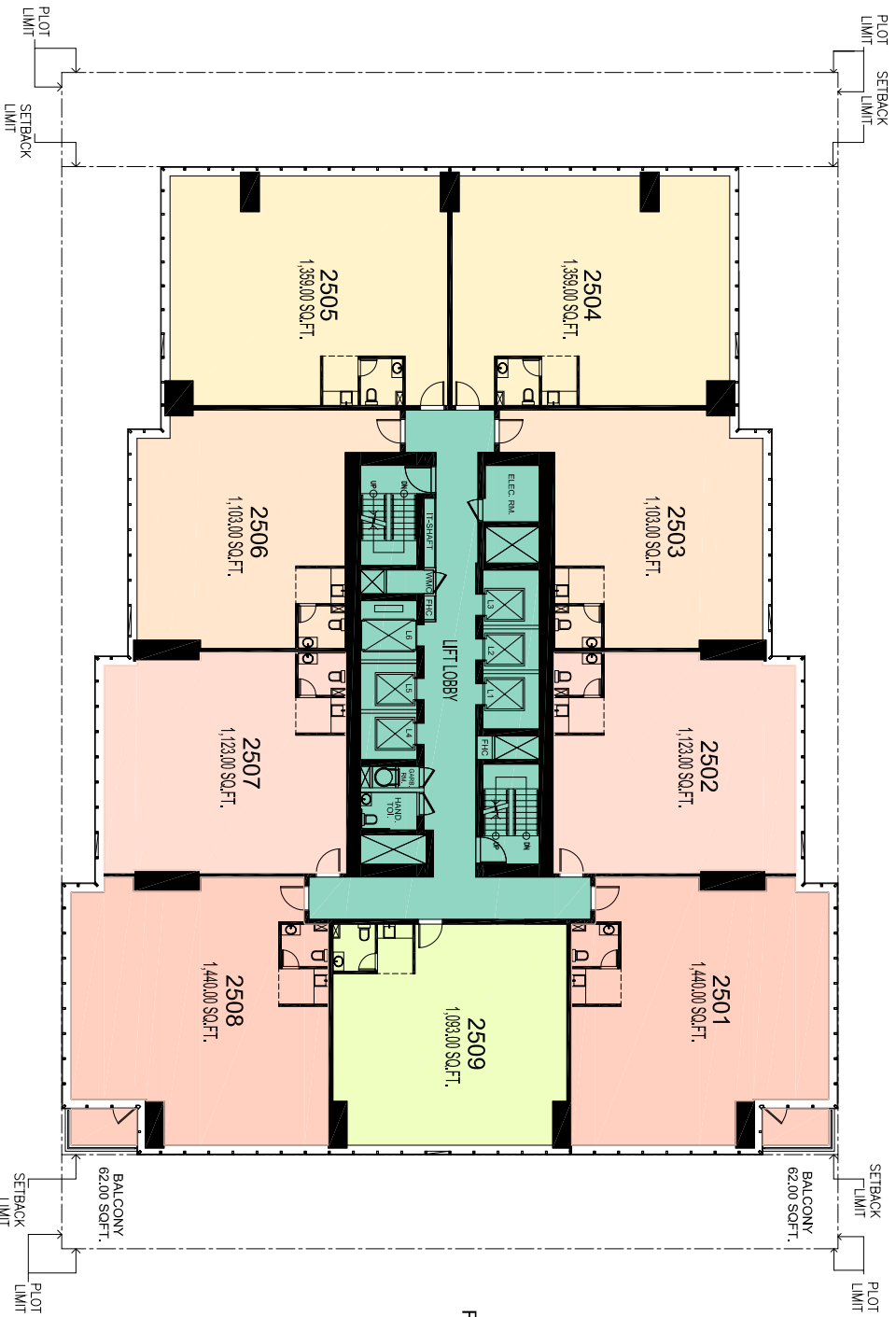

SHEIKH ZAYED ROAD 



ROUNDOABOUT SIDE



4B+G+39+M COMM.+OFFICE BUILDING
on PLOT NO-W1 (JBC 5)
JUMIRAH LAKE TOWERS, DUBAI



CLIENT
AL FAJER PROPERTIES (L.L.C.)

DRAWING NO. SP-W1-27
25TH FLOOR PLAN
21 MAY 2008